



# Abaque Peristaltic Hose Pumps

Bulletin 1101-001 E



Where Innovation Flows

[neptune1.com](http://neptune1.com)



## Pump with Confidence

### Abaque™ Peristaltic (Hose) Pumps

With more than 20 years of experience pumping and transferring difficult chemicals and fluids, the Abaque Peristaltic Hose pump will handle your toughest pumping needs – from abrasive and aggressive to shear-sensitive and viscous fluids.

Abaque pumps currently operate in some of the most demanding environments including mining, water and wastewater treatment, energy, chemical processing and OEM applications.

### Durable & Rugged

The Abaque pump housing is constructed of heavy-duty ductile iron and steel and designed to provide reliable 24/7 pump operation. The pump utilizes a rugged close-coupled gear reducer.



HDN20

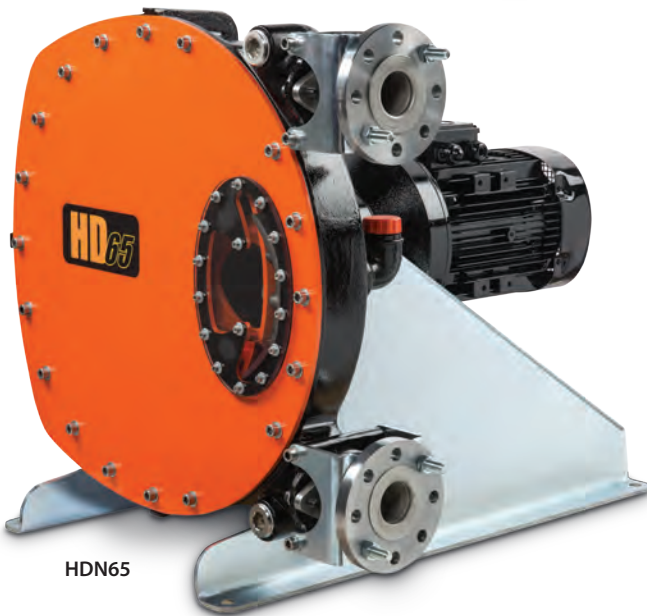

HDN65



## Principle of Operation

Pumping action is achieved by compression of a circular loop of elastomeric hose with two diametrically opposed rotating shoes. With this rotational motion fluid is pushed ahead inside a hose which is compressed and relaxed by shoes mounted on a rotor. When each shoe reaches the end of the loop, the reinforced tube immediately returns to its original shape, thereby ensuring suction and priming, creating a strong vacuum pulling more fluid inside.



Resulting in:

- **High performance:** Seal-less design eliminates leaks and product contamination, and have the ability to run dry continuously without adversely affecting the pump's performance, pressure, and accuracy (no slip).
- **Reliability:** The Abaque pump has none of the usual parts that create problems on other pumps: seats, valves, mechanical seals. The hose is the only replacement part.
- **Handling of the toughest pumping challenges,** including extremely abrasive and aggressive fluids, solid loaded liquids, as well as shear sensitive and viscous materials.

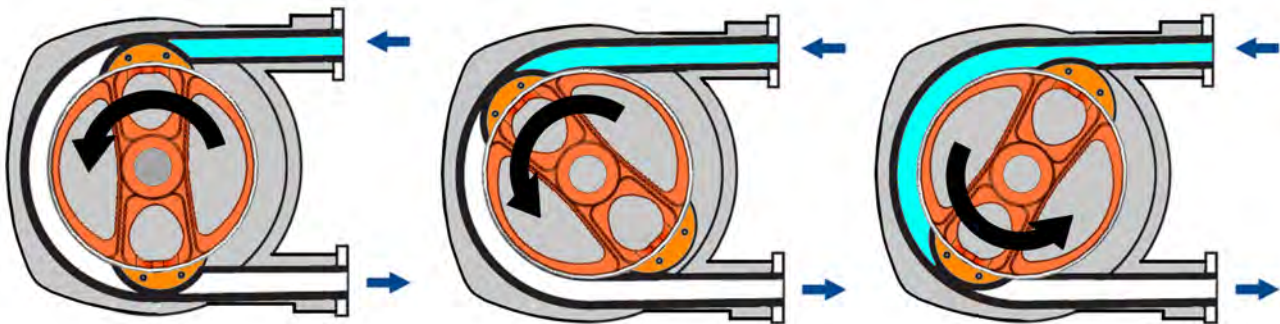

## Applications

- **Ceramic:** ceramic slips, mold filling, filter press
- **Mining:** sludge, clay slurry, lead sulfate, pyrite slurry
- **Water Treatment:** lime liquor, flocculate dispersion, sludge and slurries
- **Building Industry:** liquid or fibrous mortar, liquid plaster, light concrete
- **Chemical Industry:** acid, alcohol, detergent pumping
- **Paint & Coatings:** water base and acrylic paint, pigments, wall coating
- **Filter Press:** filling and pressing
- **Paper Industry:** latex, slurries, kaolin
- **Food Industry:** tomato sauce, mashed potatoes, gelatin, beer slurries, fish paste
- **Others:** glue, liquid salt, seed fertilizer

## Construction

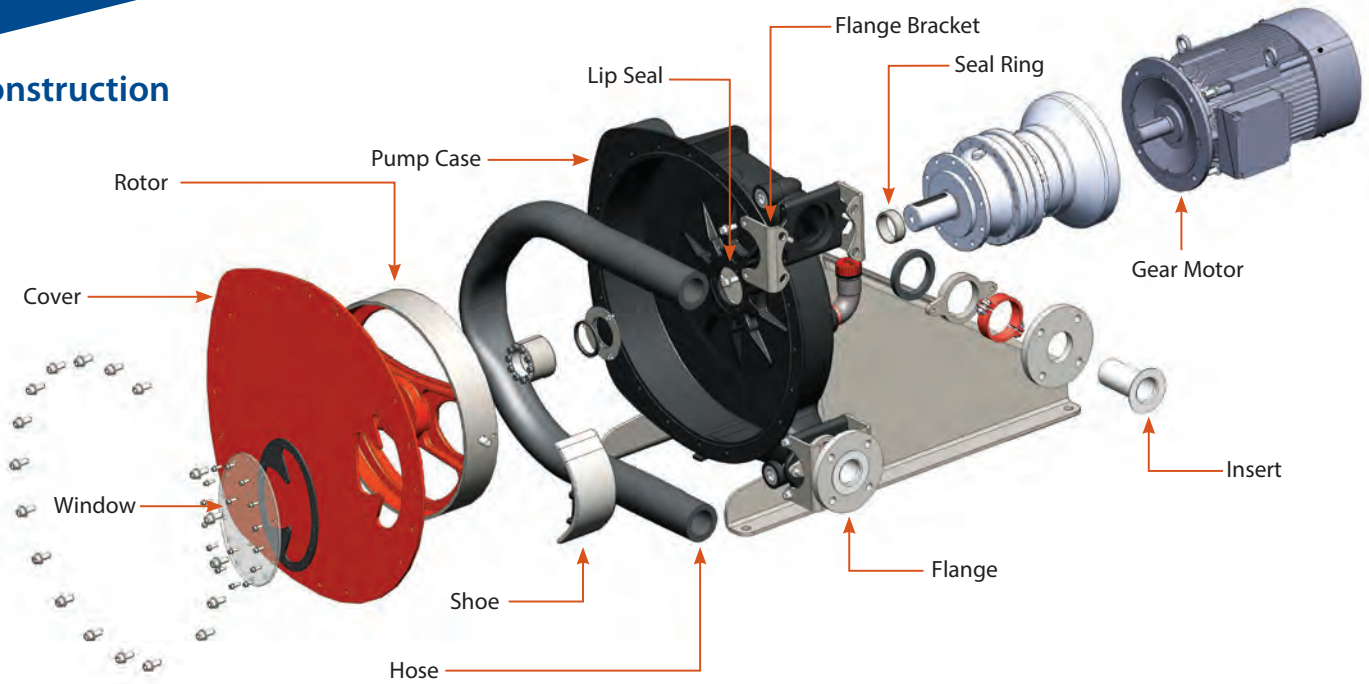

## Abaque Series Pump Construction

**Pump Case:** Ductile iron  
**Wheel:** Ductile iron  
**Shoes:** Aluminum or cast iron  
**Cover:** Steel and Plexiglas

**Flange and Brackets:** Stainless steel - ANSI or DIN  
**Hoses:** Natural rubber, Buna (NBR), EPDM or Hypalon®  
**Hoses inserts:** Stainless steel (std.), PPH or PVDF





HDNX40

## Options

The Abaque Series pump is available in thirteen different sizes, ranging from flow rates of 15 to 77,000 L/hr (.07 to 339 gpm).

Also available:

- Leak detector
- Vacuum kit
- Non-metallic inserts (PPH, PVDF)
- Pulsation dampener

## Hoses

The following hoses are available for use in the Abaque Series pump:

- **Natural rubber:** Highly resilient with excellent abrasion resistance and strength. Generally resistant to diluted acids and alcohols.
- **Buna (NBR):** Highly wear resistant to oily products (FDA approved).
- **EPDM:** High chemical resistance, especially with concentrated acids, alcohols, and ketones.
- **Hypalon®:** Resistant to chemicals, temperature extremes, and ultraviolet light.

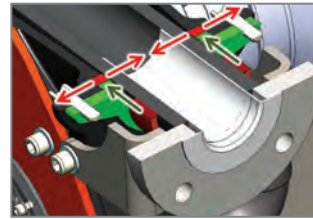

Patented Hose Holding System.

Pressing gland and square section ring provide strong hose holding and efficient tightness.



Stronger and lighter rotor design.

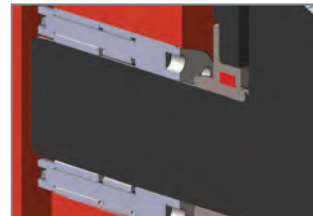

Simple, robust shaft sealing.



Large window allows for:

- Easy shimming of shoes
- Shoe removal without dismantling cover
- Ease of vacuuming pump body

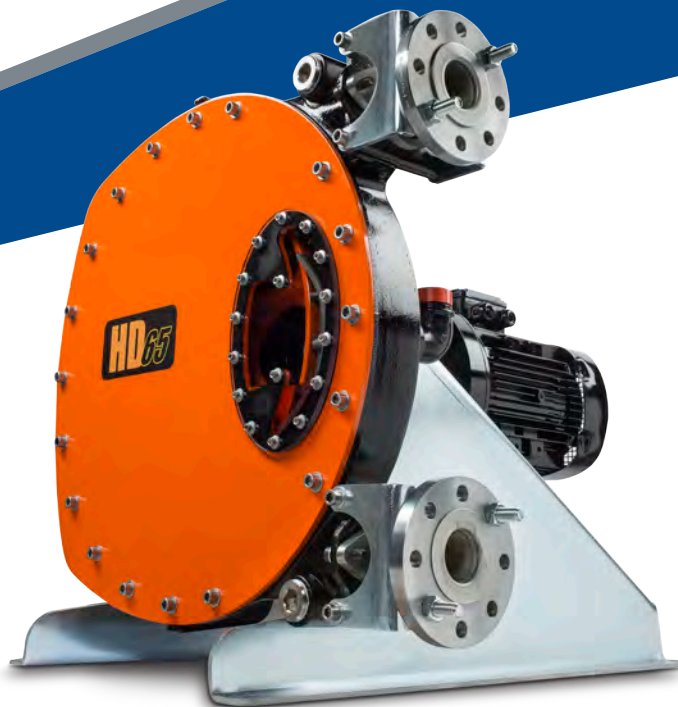

HDN65



## Durable

Ductile iron and steel construction allow higher discharge pressures to 15 bar (218 psi). Its solid construction and advanced design also reduce maintenance and repairs.

## Reliable

The Abaque Series pump is self-priming to 9 m (29.5 ft) manometric lift. This pump is able to run dry continuously without detrimental effects. The pump is capable of running in forward or reverse.

## Seal-Free

Seal-free design eliminates leaks and contamination. Fluids are contained within the hose. The hose is the primary maintenance component.

## Performance Data (GPM)

Flow Rates		10 rpm	20 rpm	30 rpm	40 rpm	50 rpm	60 rpm	70 rpm	80 rpm	90 rpm	100 rpm	110 rpm	120 rpm	130 rpm	140 rpm	Max Discharge Pressure
HDN10	gpm	0.07	0.13	0.20	0.26	0.33	0.40	0.46	0.53	0.59						116 psi
	gph	4.2	7.8	12.0	15.6	19.8	24.0	27.6	31.8	35.4						
HDN15	gpm	0.22	0.44	0.66	0.88	1.1	1.32	1.54	1.76	1.98						116 psi
HDN20	gpm	0.37	0.73	1.10	1.47	1.83	2.20	2.57	2.93	3.30						116 psi
HDN25	gpm	0.73	1.47	2.20	2.93	3.67	4.40	5.13	5.87	6.60	7.33	8.07	8.80	9.53	10.27	217 psi
HDN40	gpm	2.3	4.5	6.8	9.1	11.4	13.6	15.9	18.2	20.5	22.7	25.0	27.3	29.6	31.8	217 psi
HDNX40	gpm	3.5	7.0	10.6	14.1	17.6	21.1	24.6	28.2	31.7	35.2	38.7	42.2			217 psi
HDN50	gpm	7.4	14.9	22.4	29.9	37.4	44.9	52.3	59.8	67.3						217 psi
HDN65	gpm	8.9	17.8	26.7	35.6	44.6	53.5	62.4	71.3	80.2						217 psi
HDNX80	gpm	23.5	46.9	70.4	93.8	117.3	140.7									217 psi
HDN80	gpm	29	57	86	114	143	172									217 psi
HDN100	gpm	53	106	158	211											217 psi

**Legend**    Continuous Duty at Maximum Discharge Pressure    Continuous or Intermittent Duty Depending Upon Pressure    Intermittent Duty Only at Reduced Pressure

Charts is based on a reduced pressure of 20 psi (1.4 bar)

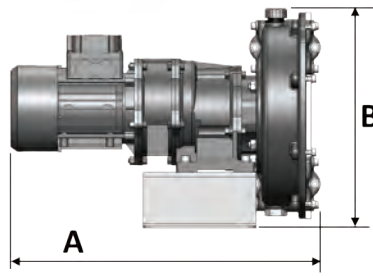
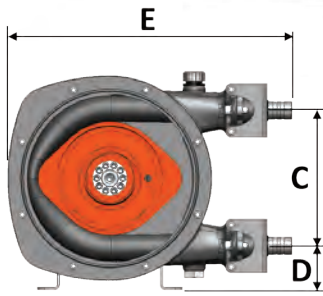

HDN10, HDN15, HDN20

HDN25, HDN32, HDN40, HDNX40

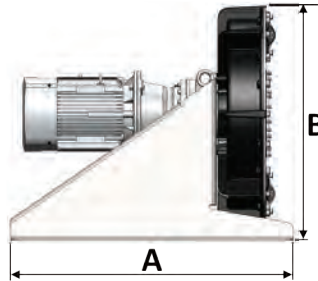
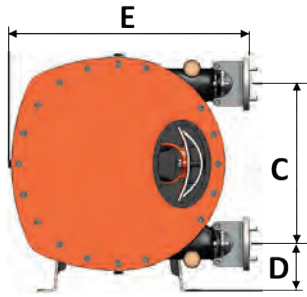
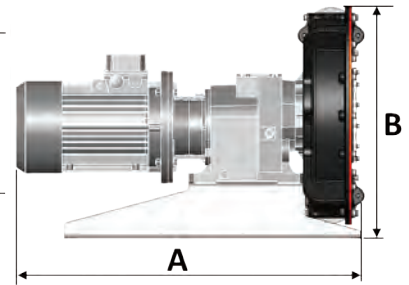
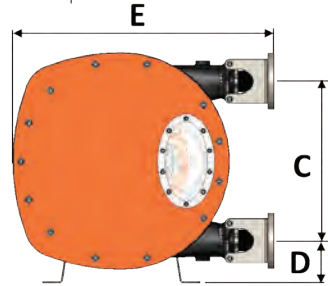

HDN50, HDN65, HDNX65, HDNX80, HDN80, HDN100

### Dimensions

		HDN10	HDN15	HDN20	HDN25	HDN32	HDN40	HDNX40	HDN50	HDN65	HDNX65	HDNX80	HDN80	HDN100
A	mm	475*	525*	525*	665	695	695	810	1,020	1,020	1,300	1,300	1,400	1,540
	in	18.7*	20.7*	20.7*	26.18	27.36	27.36	31.89	40.16	40.16	51.18	51.18	55.12	60.63
B	mm	235	325	325	430	515	515	625	825	825	1,035	1,035	1,300	1,545
	in	9.25	12.8	12.8	16.93	20.28	20.28	24.61	32.48	32.48	40.75	40.75	51.18	60.83
C	mm	115	192	192	262	330	330	430	554	554	746	746	876	1,040
	in	4.53	7.56	7.56	10.31	12.99	12.99	16.93	21.81	21.81	29.37	29.37	34.49	40.95
D	mm	70.5	62	62	98	100	100	115	164	164	186	186	262	300
	in	2.8	2.44	2.44	3.86	3.94	3.94	4.53	6.46	6.46	7.32	7.32	10.31	11.81
E	mm	310	405	405	500	620	620	706.5	835	835	1,075	1,075	1,340	1,520
	in	12.2	15.94	15.94	16.68	24.41	24.41	27.81	32.87	32.87	42.32	42.32	52.76	59.84
Weight	kg	18 - 20	26 - 32	26 - 32	71 - 83	108 - 118	113 - 123	175 - 200	295 - 345	300 - 350	625 - 635	635 - 645	875 - 965	1,175 - 1,265
	lbs	40 - 44	57 - 70	57 - 70	156 - 183	238 - 260	249 - 271	389 - 441	650 - 760	661 - 772	1,378 - 1,400	1,400 - 1,422	1,930 - 2,127	2,590 - 2,789

\* May vary, depending on gear reducer and motor.



Where Innovation Flows



PSG  
295 DeKalb Pike  
North Wales, PA 19454 USA  
P: +1 (215) 699-8700 • F: +1 (215) 699-0370  
neptune1.com

PSG reserves the right to modify the information and illustrations contained in this document without prior notice. This is a non-contractual document. 03-2016

Authorized PSG Partner:

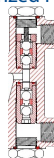

***Dosificación de Fluidos, S.A. de C.V.***

Sur 126 #113 Col. América  
C.P. 11820 Del. Miguel Hidalgo  
Ciudad de México  
Tels: 52721361, 52726384  
Email: arturoon@dosiflusa.com  
Pág. Web: www.dosiflusa.com